

Rod to tape clamp (type A)

Nominal rod diameter		Max. conductor	Weight each	Part No.
½"	12.7mm	26 x 12mm	0.15kg	CR105
¾"	16mm	26 x 12mm	0.15kg	CR105
¾"	20mm	26 x 10mm	0.15kg	CR105
¾"	16mm	30 x 2mm	0.16kg	CR108
¾"	20mm	30 x 2mm	0.16kg	CR108
¾"	16mm	40 x 12mm	0.24kg	CR110
¾"	16mm	51 x 8mm	0.30kg	CR115
¾"	20mm	51 x 12mm	0.30kg	CR125
½"	12.7mm	26 x 20mm	0.23kg	CR130
¾"	16mm	26 x 18mm	0.23kg	CR130
¾"	20mm	26 x 10mm	0.23kg	CR130
1"	25mm	26 x 10mm	0.23kg	CR130

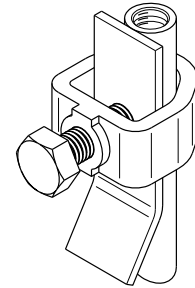

Corrosion resistance, conductivity and mechanical strength are essential considerations in clamp design to ensure an earthing system remains operative for many years. All Furse earth rod clamps have high strength copper alloy bodies and screws e.g. aluminium bronze, phosphor bronze etc., **commercial brass is not used.**

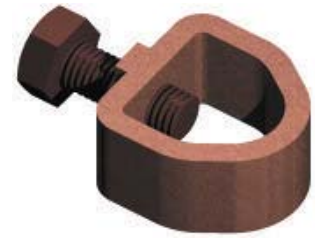

BS EN 50164-1
Class H, BS 7430



Tightening torque 15Nm

Rod to cable clamp (type G)

Nominal rod diameter		Max. conductor	Weight each	Part No.
¾"	9.5mm	6 – 35mm ²	0.03kg	CR505
½"	12.5mm	16 – 50mm ²	0.05kg	CR510-FU*
¾"	16mm	16 – 70mm ²	0.06kg	CR515*
¾"	20mm	35 – 95mm ²	0.06kg	CR520*
1"	25mm	70 – 120mm ²	0.14kg	CR525

* Suitable for use with 8mm Ø solid circular copper conductor.



BS EN 50164-1
Class H, BS 7430



Tightening torque 12Nm

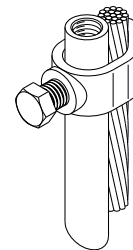

'U' bolt rod clamp (type E)

Nominal rod diameter	Hole centres	Tape width	Weight each	Part No.
¾"	37mm	-	0.20kg	CR305
¾"	37mm	-	0.20kg	CR310
1"	37mm	-	0.20kg	CR315
¾"	37mm	25mm	0.26kg	CR320*
1½"	54mm	-	0.37kg	CR325
2"	64mm	-	0.44kg	CR330

'U' Bolt threaded M10.

* CR320 includes additional plate to allow tape to be clamped without drilling.



BS 7430

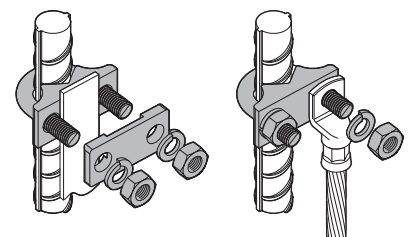

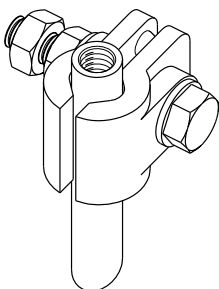
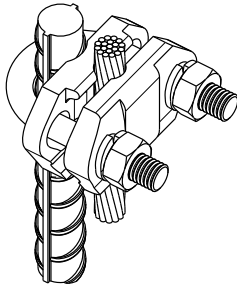

Rod to cable clamp (type GUV)

Nominal rod diameter	Conductor range	Weight each	Part No.	
5/8"	16mm	16 – 95mm ²	0.39kg	CR700*
3/4"	20mm	16 – 70mm ²	0.39kg	CR700*
5/8"	16mm	70 – 185mm ²	0.39kg	CR705
3/4"	20mm	70 – 150mm ²	0.39kg	CR705
5/8"	16mm	150 – 300mm ²	0.62kg	CR730
3/4"	20mm	150 – 300mm ²	0.62kg	CR730

* Suitable for use with 8mm Ø solid circular copper conductor.



BS EN 50164-1 Class H, BS 7430



Tightening torque 12Nm

Rod to cable lug clamp (type B)

Nominal rod diameter	Rod type	Bolt size	Weight each	Part No.	
3/8"	9.5mm	Copperbond	M8	0.09kg	CR205
5/8"	16mm	Copperbond	M10	0.30kg	CR215
5/8"	15mm	Solid copper	M10	0.30kg	CR220
3/4"	20mm	Copperbond	M10	0.30kg	CR225
3/4"	20mm	Solid copper	M10	0.30kg	CR230



BS 7430

Tower earth clamp

Conductor range	Channel thickness	Bolt size	Conductor material	Weight each	Part No.
16 – 70mm ²	10mm	M10	Copper	0.13kg	BN125*
70 – 120mm ²	10mm	M12	Copper	0.22kg	BN130
25 – 50mm ²	10mm	M10	Copper	0.08kg	BN300-FU*
25 – 50mm ²	10mm	M10	Aluminium	0.05kg	BN305*
120 – 185mm ²	10mm	M12	Copper	0.30kg	BN320
185 – 240mm ²	10mm	M12	Copper	0.40kg	BN325

For bonding copper cable or wire to steel structures.

* Suitable for use with 8mm Ø solid circular conductor.



BS EN 50164-1 Class H, BS 7430



Tightening torque 12Nm