

The following pages (59 – 62) detail the products required to install a ‘cable and wire’ lightning protection system. Additionally, accessories can be found on pages 63 – 64.

Details of the cable and wire conductors can be found in the Conductors section.

Air rod

Rod length	Rod diameter	Thread diameter	Material	Weight each	Part No.
500mm	15mm	16mm	Copper	0.73kg	RA215
1000mm	15mm	16mm	Copper	1.51kg	RA225
1500mm	15mm	16mm	Copper	2.35kg	RA230 NEW
2000mm	15mm	16mm	Copper	3.00kg	RA240
3000mm	15mm	16mm	Copper	4.70kg	RA250 NEW

Manufactured from high conductivity hard drawn copper, with rolled threads. Supplied complete with locknut.

“Field Trials in the United States, carried out over many years research have confirmed that blunt air rods are struck by lightning in preference to taper pointed air rods.”

“Lightning rod improvement studies” by C B Moore, W Rison, J Mathis, G Aulich. Journal of Applied Meteorology, May 2000.

Note: during high winds and extreme weather conditions air rods over 1000mm long can be subjected to fatigue mechanisms. It is therefore recommended that additional supports are considered before installation.



BS EN 50164-2

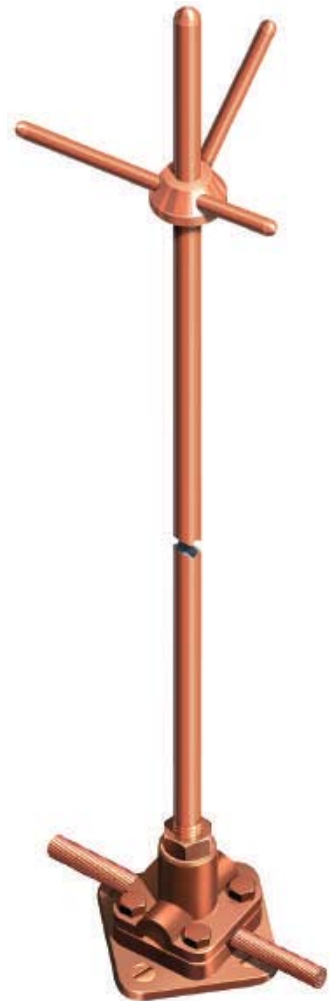

Multiple point

Rod diameter	Material	Weight each	Part No.
15mm	Copper	0.27kg	RA600

Manufactured from high conductivity hard drawn copper, suitable for use with copper air rods only.

Flat saddle

Conductor size	Rod diameter	Thread diameter	Conductor material	Weight each	Part No.
50mm	15mm	16mm	Copper	1.03kg	SD155
70mm	15mm	16mm	Copper	0.95kg	SD160
95mm	15mm	16mm	Copper	0.95kg	SD165

Manufactured from a high quality copper alloy. Simple to install, providing an effective connection between air rod and stranded air termination conductors.



BS EN 50164-1 Class H



Fix using countersunk wood screws 1½" No. 10 or M6 (Part no. SW005) and wall plugs (Part no. PS305) – see Accessories page 63.



Tightening torque 12Nm

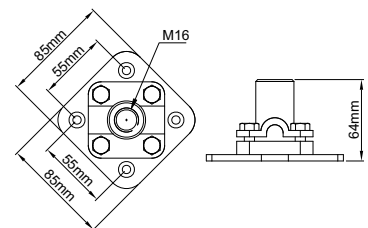

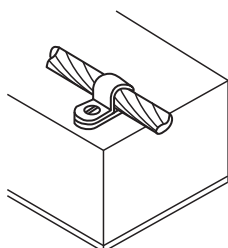
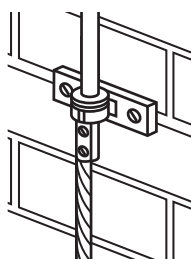
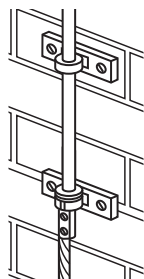

Rod brackets

Rod diameter	Rod material	Weight each	Part No.
15mm	Copper	0.90kg	BR105

Manufactured from high quality copper alloy. Simple to install, providing an effective means of mounting an air rod on a vertical surface e.g. a chimney stack. Use in conjunction with the rod to cable coupling.



Fix using roundhead wood screws 1½" No. 12 or M8

Rod to cable coupling

Rod diameter	Thread diameter	Conductor size	Conductor material	Weight each	Part No.
15mm	16mm	50 – 70mm ²	Copper	0.25kg	CG705
15mm	16mm	95mm ²	Copper	0.25kg	CG710

Manufactured from high quality copper alloy. Provides an effective connection between air rod and stranded air termination conductor. Use in conjunction with rod brackets.



BS EN 50164-1 Class H



Tightening torque 6Nm

One hole cable clip

Conductor size	Conductor material	Weight each	Part No.
50mm ²	Copper	0.01kg	CP910
70mm ²	Copper	0.01kg	CP915
95mm ²	Copper	0.01kg	CP920

Manufactured from pure copper, these simple pressed clips are available to suit a range of stranded copper conductors.



Fix using roundhead wood screws 1½" No. 10 or M6 (Part no. SW305) and wall plugs (Part no. PS305) – see Accessories page 63.

Heavy duty cast cable saddle

Conductor size	Conductor material	Weight each	Part No.
50mm ²	Copper	0.10kg	CP810
70mm ²	Copper	0.10kg	CP815
95mm ²	Copper	0.10kg	CP835

Manufactured from high quality copper alloy. Simple to install, providing an effective fixing for stranded copper cables.



Fix using countersunk wood screws 1½" No. 10 or M6 (Part no. SW005) and wall plugs (Part no. PS305) – see Accessories page 63.

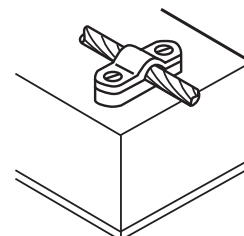

Test clamp

Conductor size	Conductor material	Weight each	Part No.
50mm ²	Copper	0.39kg	CR855
70mm ²	Copper	0.40kg	CR860
95mm ²	Copper	0.40kg	CR865

Manufactured from high quality copper alloy. Simple to install, providing an effective low resistance overlap connection between stranded copper cables.



BS EN 50164-1 Class H



Fix using countersunk wood screws 1½" No. 10 or M6 (Part no. SW005) and wall plugs (Part no. PS305) – see Accessories page 63.



Tightening torque 12Nm

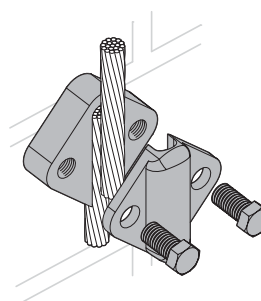

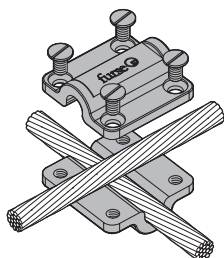

Square conductor clamp

Conductor size	Conductor material	Weight each	Part No.
50mm ²	Copper	0.32kg	CR810
70mm ²	Copper	0.29kg	CR815
95mm ²	Copper	0.25kg	CR820

Manufactured from high quality copper alloy. Simple to install, providing an effective low resistance connection between overlapping stranded conductors allowing cross, tee, through and right angle joints to be formed.



BS EN 50164-1 Class H



Tightening torque 6Nm

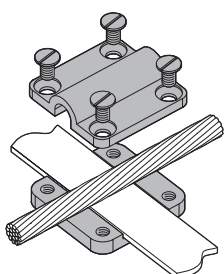

NEW Cable to tape square clamp

Conductor size	Conductor material	Weight each	Part No.
25 x 3mm to 70mm ²	Copper	0.30kg	CT130

Manufactured from high quality copper alloy. Simple to install, providing an effective low resistance connection between conductor tape and stranded copper conductor.



BS EN 50164-1 Class H



Fix using countersunk wood screws 1½" No. 10 or M6 (Part no. **SW005**) and wall plugs (Part no. **PS305**) – see Accessories page 63.



Tightening torque 5Nm